

# Assembly and Mounting Instructions

## Water Bowl #MA04

**Please read and follow instructions:**

- 1: Insert metal plate (MA04-3) inside water bowl and align with holes in back of bowl. Secure plate with bolts used to fasten onto u-bolt, backplate, or wall. (bolts are not included). You may wish to mount your bowl and secure the bolts before complete assembly of bowl.
- 2: Install float assembly inside bowl with threaded valve inserted through valve hole on left or right side of bowl. Close the remaining valve hole by inserting the plastic plug from the outside of the bowl.
- 3: Connect to water supply and turn on water pressure (up to 60 PSI).
- 4: Adjust float on float arm to control water depth in bowl. Tighten #761 brass bolt and nut to insure desired water level.
- 5: Fasten plastic float chamber cover to bowl using 1/4" x 1" bolts/washers/nuts.

**OPTIONAL PARTS:**

1 1/4", 1 1/2", and 2" u-clamps  
for mounting on pipes

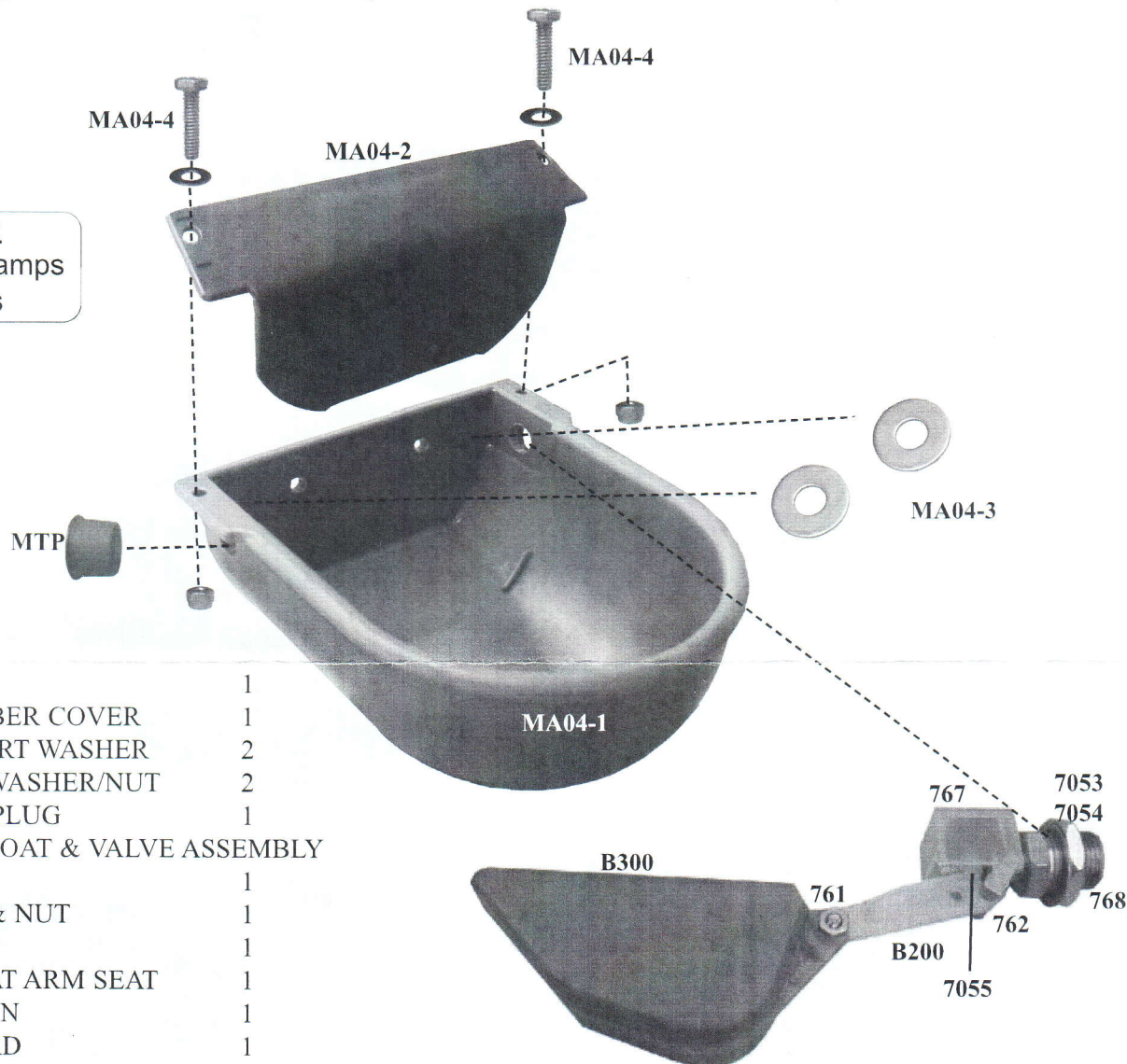

**PARTS LIST:**

MA04-1	BOWL ONLY	1
MA04-2	FLOAT CHAMBER COVER	1
MA04-3	METAL SUPPORT WASHER	2
MA04-4	1/4" x 1" BOLT/WASHER/NUT	2
MTP	VALVE HOLE PLUG	1
766	COMPLETE FLOAT & VALVE ASSEMBLY	
B300	FLOAT	1
761	BRASS BOLT & NUT	1
B200	FLOAT ARM	1
7055	RUBBER FLOAT ARM SEAT	1
762	FLOAT ARM PIN	1
767	SPLASH GUARD	1
768	BRASS VALVE	1
7053	VALVE WASHER	1
7054	VALVE NUT	1

Manufactured In Canada by:  
SMB MFG. INC.

6376 SIDEROAD 18, WALLENSTEIN, ON N0B 2S0  
TEL: 519-669-1537 TOLL FREE: 1-800-663-3955 FAX: 519-669-1022  
WWW.SMBMFG.COM